



Greenfield Close, Liphook

Price Guide £375,000



Williams of Petersfield

INDEPENDENT ESTATE AGENTS

Greenfield Close, Liphook

This property presents an exceptional opportunity to create your perfect forever family home, with plenty of scope to add your personal touch and make it truly your own. Positioned in a highly sought-after cul-de-sac, the location offers the convenience, being just a short walk from well-regarded local schools, shops, and everyday amenities. With its generous potential, this home provides the perfect foundation for family living for many years to come.

As you enter through the front door, you are welcomed by a spacious and bright hallway with convenient under-stairs storage. This flows into an open-plan kitchen and breakfast room, fitted with a range of eye-level and base units. The ground floor also features a lovely sitting room with a fireplace and patio doors opening onto a charming patio area. The garage offers excellent storage space and also presents potential for conversion into a studio or home office.

Upstairs, you'll find three generously sized bedrooms, all benefiting from fitted wardrobes, along with a well-proportioned family bathroom.

Outside, the property boasts a private front garden with mature shrubs, as well as ample parking on a long driveway leading to the garage. To the rear, there is a lovely lawn surrounded by deep flower borders, along with two additional lawned areas adorned with a variety of shrubs and trees. The property is set within a sought-after residential area, making it an ideal family home.

EPC - D

Council Tax - D



Location - Liphook

Located near the centre of the village of Liphook with its range of shops including Sainsbury's supermarket, doctors surgeries and library. Liphook station is on the Waterloo/Portsmouth mainline with a journey time to London of about an hour. There is an excellent choice of both state and private schools within the vicinity including Churchers Junior School and Bohunt Secondary School which won the TES Secondary School of the Year in 2014. There are many acres of fine countryside close at hand including much under the ownership of the National Trust.

Local authority

East Hampshire District Council
Penns Place, Petersfield
Hampshire, GU31 4EX

Additional Information

All main services

Tenure

Freehold

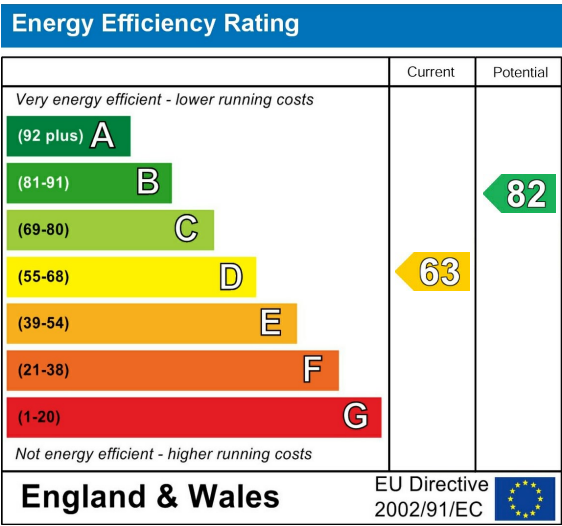

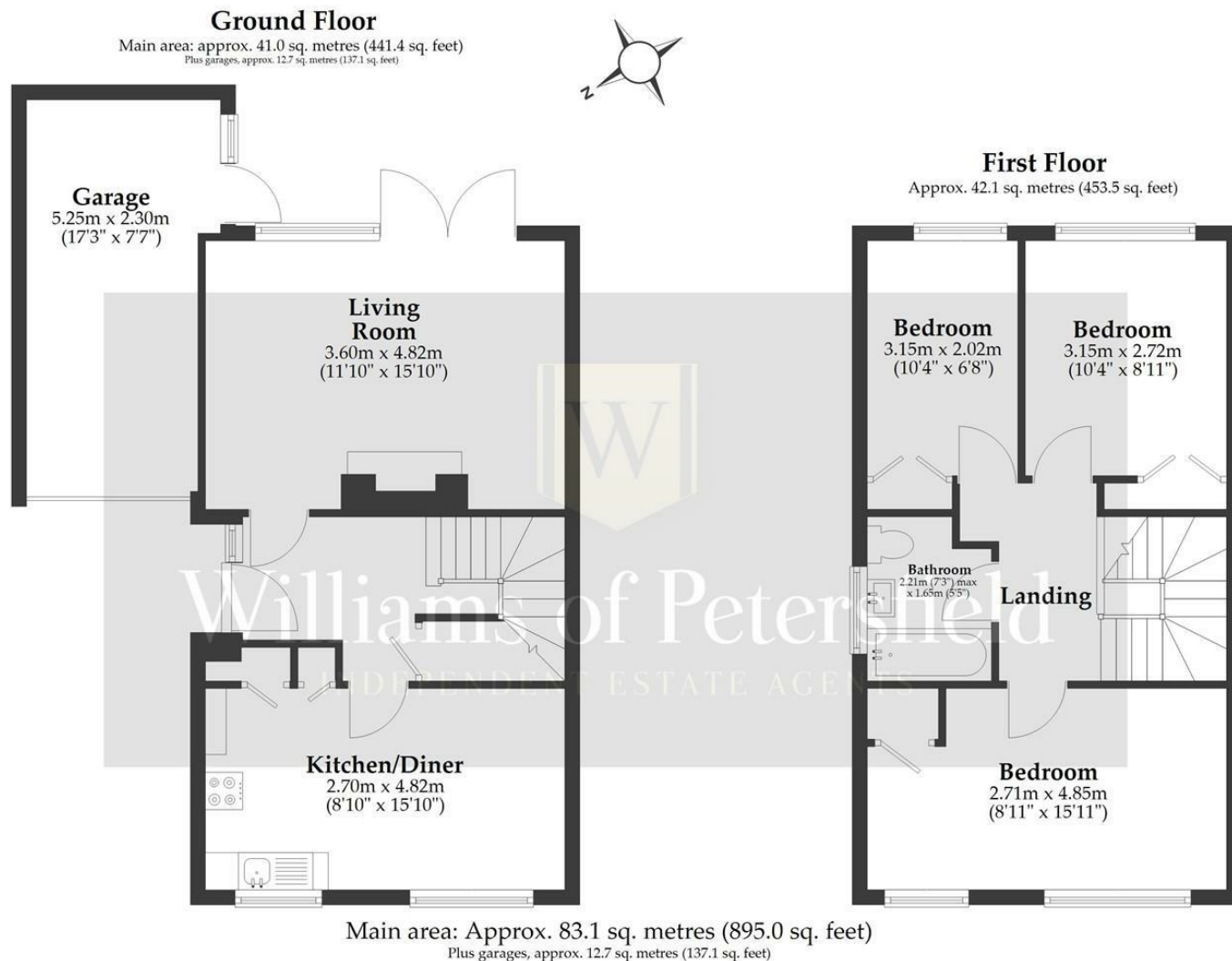

This plan has been produced by E Property Marketing for illustrative purposes only and should be used as such by any prospective purchaser. Whilst every effort has been made to ensure the accuracy of this plan, measurements of doors, windows, rooms, and other items are approximate. No responsibility is taken for any error, omission, or misstatement.

Williams of Petersfield

6 - 8 College Street, Petersfield, Hampshire, GU31 4AD

01730 233333 sales@williamsopetersfield.co.uk www.williamsopetersfield.co.uk

The Property Misdescriptions Act 1991: The Agent has not tested any apparatus, equipment, fixtures and fittings or services and so cannot verify that they are in working order or fit for the purpose. A buyer is advised to obtain verification from their solicitor or surveyor. References to the tenure of a property are based upon information supplied by the seller. The agent has not had sight of the title documents. A buyer is advised to obtain verification from their solicitor. Items shown in photographs are NOT included unless specifically mentioned within the sales particulars. They may however be available by separate negotiation. Buyers must check the availability of any property and make an appointment to view before embarking on any journey to see a property.