



Duckmead Lane, Liss

Price Guide £625,000



Williams of Petersfield

INDEPENDENT ESTATE AGENTS

Duckmead Lane, Liss

Welcome to Mint Cottage, a delightful extended Victorian cottage, tucked away in a private corner plot on Duckmead Lane, Liss. This charming three-bedroom property is full of warmth, character and potential, surrounded by open fields and beautiful countryside walks. Mint Cottage is only a short drive away from Liss Village and Petersfield town centre. There is great potential for modernising and extending to create your dream family home in the country.

From the moment you step through the porch, you're welcomed by a home that feels both peaceful and inviting. The living room features an open fireplace and sits at the front of the property, while a second reception space offers flexibility as a snug, dining area or playroom. The kitchen enjoys double-aspect windows overlooking the rear garden and farmland, with a utility room, downstairs W.C., and back door completing the downstairs.

Upstairs, three spacious double bedrooms benefit from a calming rural outlook. The first bedroom features built-in storage and an open en-suite shower room, while the family bathroom enjoys views across the countryside through a large window. The other two bedrooms are generously sized, perfect for families, or for a study / dressing room.

The garden is a true highlight, south-facing, spacious, and private. Whether you're enjoying morning coffee under the pergola or relaxing with an evening drink surrounded by lavender, this outdoor space is a joy year-round. A vegetable patch adds to the charm as well as a practical garden shed. Finally, the garage sits at the front of the property, ideal for storage or potential home office.

Contact Williams of Petersfield today, do not miss out on this fantastic opportunity.

No onward chain.
Council Tax - E
EPC - E



Location - Liss

The village of Liss provides a wide range of shopping and recreational facilities, infant and junior schools, churches, doctors and dental surgeries, restaurants and pubs. The village has a mainline station on the Portsmouth – London Waterloo line and the A3 provides road access to the south coast, Guildford and the M25. Liss is set within the South Downs National Park, which provides some magnificent walking and riding country, as well as many other outdoor leisure amenities. There are theatres at Guildford and Chichester, golf at Petersfield, Liphook and Cowdray Park, as well as convenient access to the well regarded Churchers College, Hlghfield & Brookham and Bedales Schools.

Local authority

East Hampshire District Council
Penns Place, Petersfield
Hampshire, GU31 4EX

Additional Information

Mains electric
Oil heating
Mains drainage

Tenure

Freehold

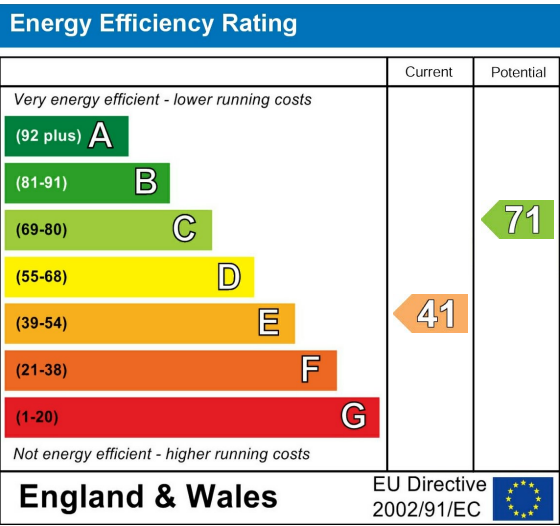

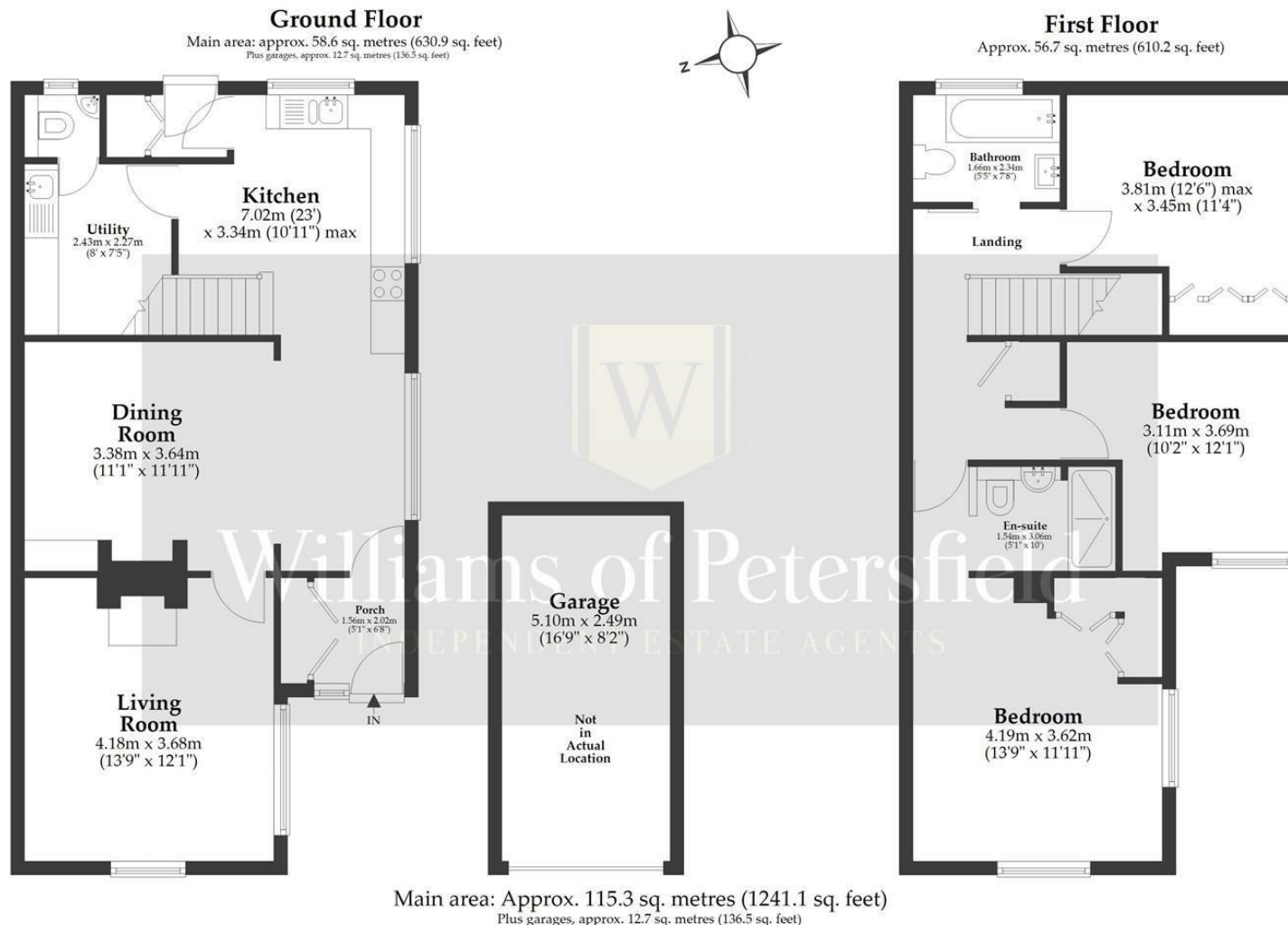

This plan has been produced by E Property Marketing for illustrative purposes only and should be used as such by any prospective purchaser. Whilst every effort has been made to ensure the accuracy of this plan, measurements of doors, windows, rooms, and other items are approximate. No responsibility is taken for any error, omission, or misstatement.

Williams of Petersfield

6 - 8 College Street, Petersfield, Hampshire, GU31 4AD

01730 233333 sales@williamsopetersfield.co.uk www.williamsopetersfield.co.uk

The Property Misdescriptions Act 1991: The Agent has not tested any apparatus, equipment, fixtures and fittings or services and so cannot verify that they are in working order or fit for the purpose. A buyer is advised to obtain verification from their solicitor or surveyor. References to the tenure of a property are based upon information supplied by the seller. The agent has not had sight of the title documents. A buyer is advised to obtain verification from their solicitor. Items shown in photographs are NOT included unless specifically mentioned within the sales particulars. They may however be available by separate negotiation. Buyers must check the availability of any property and make an appointment to view before embarking on any journey to see a property.