



The Shrubbery, Denmead

£1,400 PCM



Williams of Petersfield

INDEPENDENT ESTATE AGENTS

The Shrubby, Denmead

This two bedroom semi-detached house lies in a central location within the heart of the village of Denmead.

Internally the property benefits from attractive well proportioned accommodation featuring an entrance hall, cloakroom, kitchen with AEG hob & oven, lounge with French double glazed doors leading to the rear garden.

To the first floor are two double bedrooms, one with built in wardrobe space as well as the family bathroom.

The property has front and rear gardens with gated access to the rear garden and allocated parking for two cars.

The property has been professionally decorated throughout as well as new carpets

No Pets

EPC - C

Council Tax - C

Available from End September 2025



Additional Information

All main services

Local Authority - Winchester

Winchester City Council
City Offices
Colebrook Street
Winchester
SO23 9LY

01962 840222

Energy Efficiency Rating		
	Current	Potential
Very energy efficient - lower running costs		
(92 plus) A		91
(81-91) B		
(69-80) C	77	
(55-68) D		
(39-54) E		
(21-38) F		
(1-20) G		
Not energy efficient - higher running costs		
England & Wales		EU Directive 2002/91/EC
		



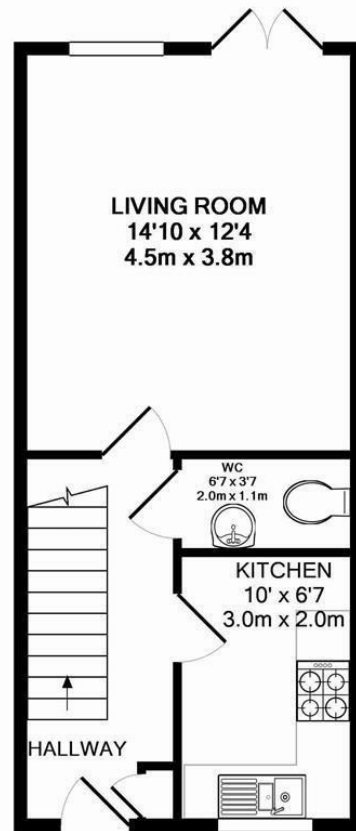

GROUND FLOOR
APPROX. FLOOR
AREA 350 SQ.FT.
(32.5 SQ.M.)

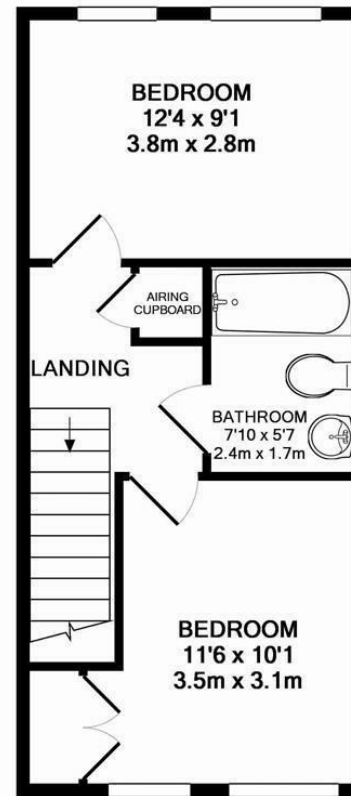

1ST FLOOR
APPROX. FLOOR
AREA 350 SQ.FT.
(32.5 SQ.M.)

TOTAL APPROX. FLOOR AREA 699 SQ.FT. (65.0 SQ.M.)

Whilst every attempt has been made to ensure the accuracy of the floor plan contained here, measurements of doors, windows, rooms and any other items are approximate and no responsibility is taken for any error, omission, or mis-statement. This plan is for illustrative purposes only and should be used as such by any prospective purchaser. The services, systems and appliances shown have not been tested and no guarantee as to their operability or efficiency can be given
Made with Metropix ©2013

Williams of Petersfield

6 - 8 College Street, Petersfield, Hampshire, GU31 4AD

01730 233333 sales@williamsopetersfield.co.uk www.williamsopetersfield.co.uk

The Property Misdescriptions Act 1991: The Agent has not tested any apparatus, equipment, fixtures and fittings or services and so cannot verify that they are in working order or fit for the purpose. A buyer is advised to obtain verification from their solicitor or surveyor. References to the tenure of a property are based upon information supplied by the seller. The agent has not had sight of the title documents. A buyer is advised to obtain verification from their solicitor. Items shown in photographs are NOT included unless specifically mentioned within the sales particulars. They may however be available by separate negotiation. Buyers must check the availability of any property and make an appointment to view before embarking on any journey to see a property.