



Thomas Road, Hampshire

£1,400 PCM



Williams of Petersfield

INDEPENDENT ESTATE AGENTS

Thomas Road, Hampshire

We are pleased to offer for let this great modern house in the much requested Rams Hill estate.

The property features two bedrooms, two bathrooms a modern kitchen and a spacious lounge-diner. It is modern throughout and also has a nice enclosed rear garden and a single garage as well as a ground floor cloakroom.

Council Tax Band -C

EPC -C



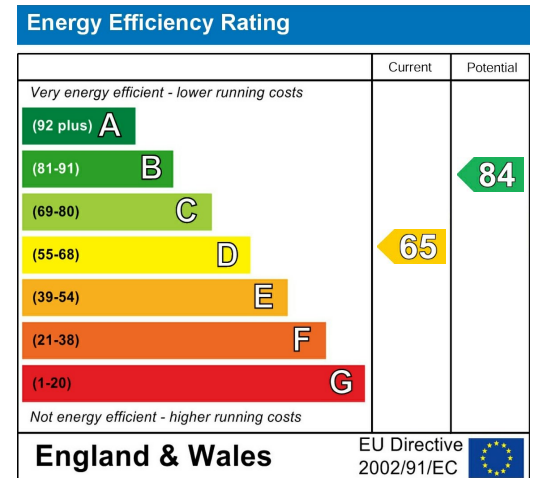

IMPORTANT NOTICE: Williams of Petersfield and its clients give notice that: they have no authority to make or give any representations or warranties in relation to the property. These particulars do not form any part of any offer or contract and must not be relied upon as statements or representations of fact. Any areas, measurements or distances are approximate. The text, photographs and plans are for guidance only and are not necessarily comprehensive. It should not be assumed that the property has all necessary planning, Building Regulation or other consents and Williams of Petersfield have not tested any services, equipment or facilities. Purchasers must satisfy themselves by inspection or otherwise.

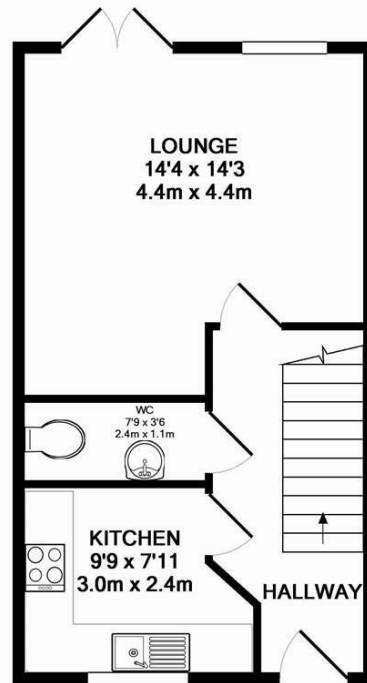

GROUND FLOOR
APPROX. FLOOR
AREA 367 SQ.FT.
(34.1 SQ.M.)

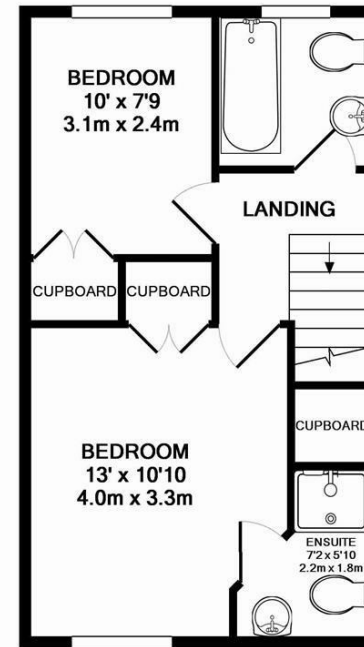

1ST FLOOR
APPROX. FLOOR
AREA 367 SQ.FT.
(34.1 SQ.M.)

TOTAL APPROX. FLOOR AREA 733 SQ.FT. (68.1 SQ.M.)

Whilst every attempt has been made to ensure the accuracy of the floor plan contained here, measurements of doors, windows, rooms and any other items are approximate and no responsibility is taken for any error, omission, or mis-statement. This plan is for illustrative purposes only and should be used as such by any prospective purchaser. The services, systems and appliances shown have not been tested and no guarantee as to their operability or efficiency can be given
Made with Metropix ©2012

Williams of Petersfield

6 - 8 College Street, Petersfield, Hampshire, GU31 4AD

01730 233333 sales@williamsopetersfield.co.uk www.williamsopetersfield.co.uk

The Property Misdescriptions Act 1991: The Agent has not tested any apparatus, equipment, fixtures and fittings or services and so cannot verify that they are in working order or fit for the purpose. A buyer is advised to obtain verification from their solicitor or surveyor. References to the tenure of a property are based upon information supplied by the seller. The agent has not had sight of the title documents. A buyer is advised to obtain verification from their solicitor. Items shown in photographs are NOT included unless specifically mentioned within the sales particulars. They may however be available by separate negotiation. Buyers must check the availability of any property and make an appointment to view before embarking on any journey to see a property.